



# 7 Reasons



# Outshines The Competition

Designed for complex real-world enterprise requirements where you need the speed of “no-code” along with the power and ability to customize offered by “low-code”



# 1 TransForm is the only product that works *fully* when there is no reliable wifi or cellular signal.

When offline, data can be captured and, unlike other products, because of its patented approach, data can be looked up, and documents, diagrams and video can be retrieved from an SQLite on-device data base. Plus, TransForms intelligent synchronization avoids any data conflicts.

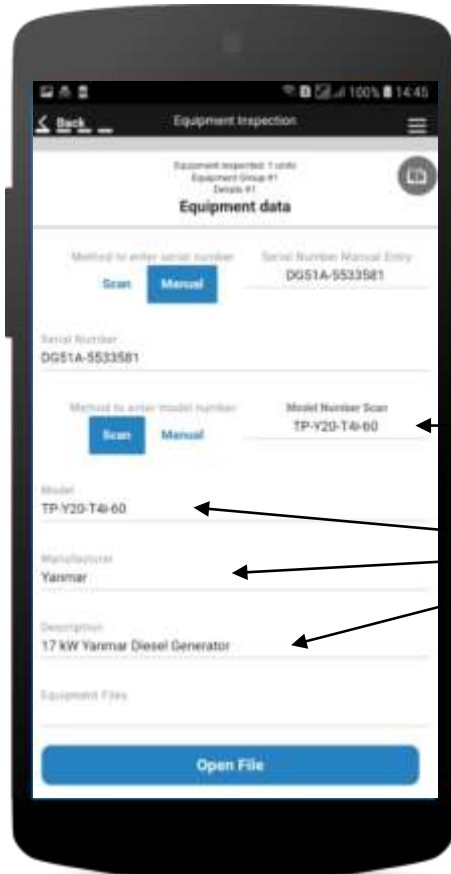

Scan barcode



Store barcode

Lookup barcode from on-device SQLite database and populate form fields with reference data

Access relevant on-device files (PDFs, videos, images etc.) via suitable native mobile device apps

No connection is necessary. The process can be completed entirely offline!



# 2 TransForm Programming/Scripting Language (TPL)

TPL allows developers to add powerful client-side calculations, validations behaviors, and web service interfaces. With TPL one can be confident that you will not run out of the power, and you will have an unlimited ability to meet complex real-world requirements.



## Data Input Validation

- Verify Value & Range
- Check Input Limits
- Compare with Stored or External Values



## Web API Integration

- Call Web Service for Selection Info
- Call Web Service to Validate Value
- Call Web Service to Push Data



## Workflow Process Enablement

- Manage Form 'State'
- Trigger Actions Based on 'State'
- Compare & Direct 'State' Based on Form Data



## Calculations

- On-Device Calculated Fields
- Calculate Limits for Validation
- Perform Complex On-Device Calculations

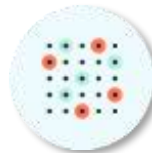

## Advanced User Interface Behaviors

- Manage Form 'State'
- Trigger Actions Based on 'State'
- Compare & Direct 'State' Based on Form Data



# TPL More Examples – Custom Styling

Custom visual elements makes it easier and faster to make selections

Phone number field - US currency formatting  
15

Date field - friendly date formatting  
2016-03-25

Button-list field plain  
First Button Second Button

Button-list field  
Yes No

Button-list Multi-value field  
Red Orange Yellow Green Blue Indigo Violet

Button-list Multi-value field w/styles no title  
Red Orange Yellow Green Blue Indigo Violet

Checklist Multi-value field  
Red Orange Yellow Green Blue Indigo Violet

Button-list Multi-value field with Afters  
Red Orange Yellow Green Blue Indigo Violet

Button-list with Button Function  
First Button Second Button



Phone number field - US currency formatting  
\$15.00

Date field - friendly date formatting  
Friday the 25th of March 2016

Button-list field plain  
First Button Second Button

Button-list field  
The value is: No  
Yes No

Button-list Multi-value field  
The value is: Orange  
Red Orange Yellow Green Blue Indigo Violet

Button-list Multi-value field w/styles no title  
Red Orange Yellow Green Blue Indigo Violet

Checklist Multi-value field  
The value is: Orange  
☐ Red ☒ Orange ☐ Yellow ☐ Green ☐ Blue ☐ Indigo ☐ Violet

Button-list Multi-value field with Afters  
The value is: Orange  
Red | Orange | Yellow  
Green | Blue | Indigo | Violet

Button-list with Button Function  
The value is: 4,20  
4 20 Reset



# TPL examples – Data Driven Forms whereby unlimited variations of forms can be automatically created

Transform manages 1000s of different questions/tests for 1000s of different items with a single form!

A single dynamic form for all items/tests

Enter a reference (e.g. part number)

Specific tests retrieved out of database of 1000s

Form questions created "on the fly"  
from retrieved data, with test specs

Enter measurement

Specifications	Test Method	Test Data
Appearance Creamy, opaque viscous liquid with minimal aeration, compares to standard	Visual	<input checked="" type="checkbox"/> Meets Spec <input type="checkbox"/> Fails Spec
Color White to off-white - Compares to standard	Visual	<input checked="" type="checkbox"/> Meets Spec <input type="checkbox"/> Fails Spec
Odor Compares to standard	Sensory	<input type="checkbox"/> Meets Spec <input checked="" type="checkbox"/> Fails Spec
Viscosity @ 23.5 - 26.5°C (RVT Spindle #3 @ 10RPM) 2500 - 5500 Finished 2600	AN 07-01	<input checked="" type="checkbox"/> Meets Spec <input type="checkbox"/> Fails Spec
pH @ 25°C 6.5 - 7.5	AN 06-01	<input checked="" type="checkbox"/> Meets Spec <input type="checkbox"/> Fails Spec

Checked against dynamic spec

Automatic pass/fail

# 3 Responsive Layouts That Optimize For Any Device

Responsive TransForm layouts allow for multiple fields on a line and will resize appropriately for any screen. And TransForm's mobile optimized controls will accelerate your data entry processes.

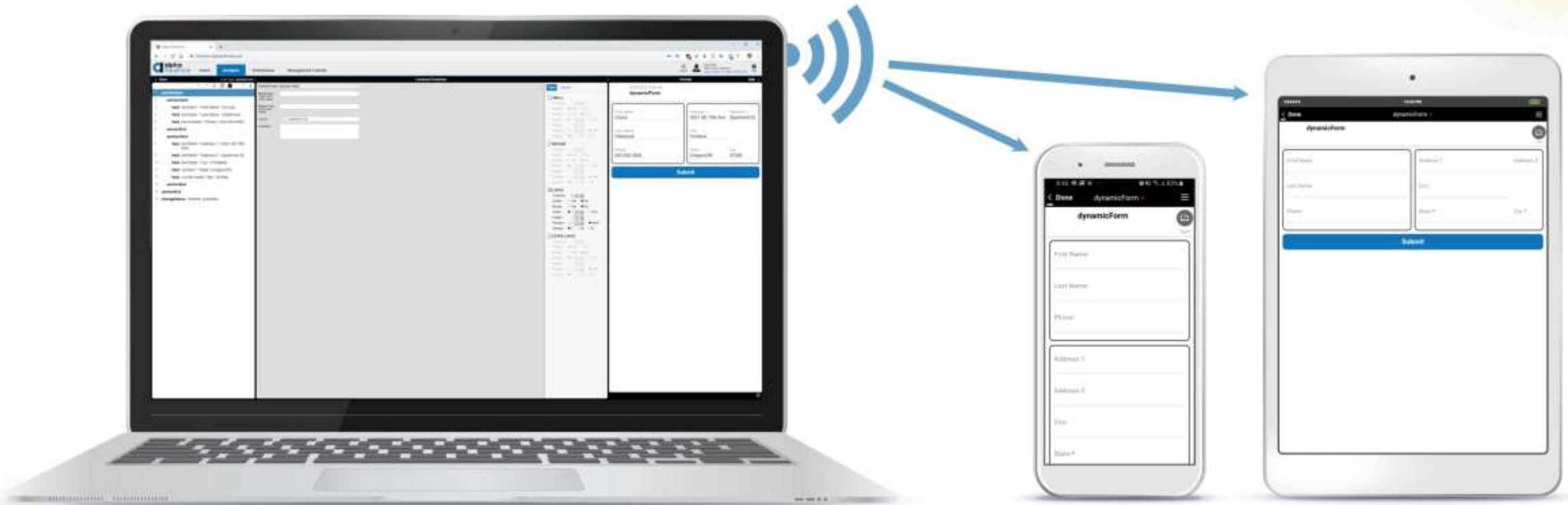

# 4 Seamless Integration With Existing Systems

TransForm will seamlessly integrate with your digital workflows, systems of record, and web services.

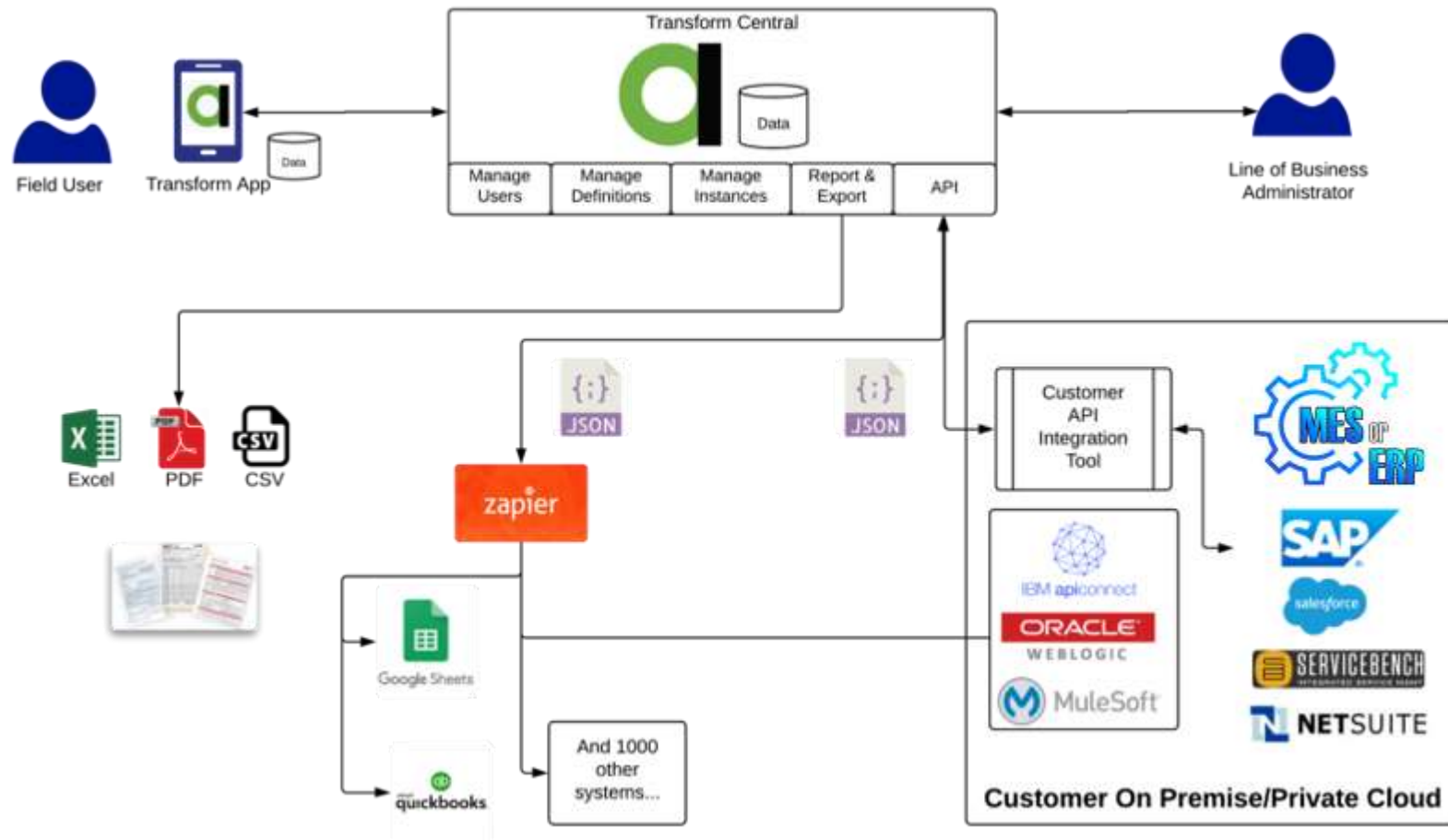

# 5 Works With Data Structures Of Any Complexity

Transform Has The Ability To Work With Complex Data Structures (Parent, Child, Grandchild, Sibling, Etc.) Without The Form Designer Having To Worry About The Data Structure.

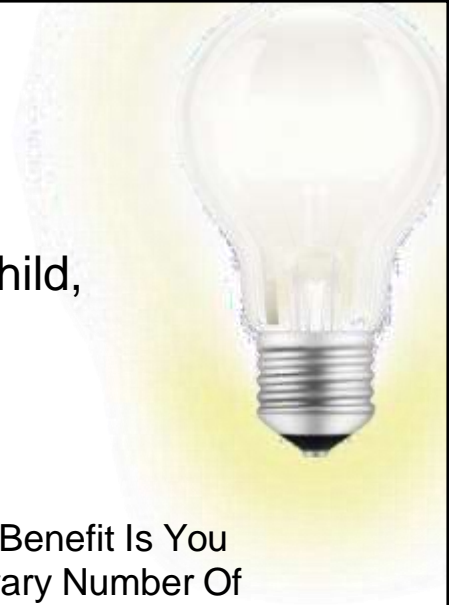

An example of this Benefit Is You Can Have An Arbitrary Number Of Batteries in a battery bank that need to be inspected

You want to be able to handle 1 battery or  $x$  batteries (where  $x$  is any number)

In turn you may want to take an arbitrary number of pictures for each battery and have an arbitrary number of voice recordings for each picture



# 6 Confidently Manage Operations with Workflows

TransForm backend does all the heavy lifting so that your work flows smoothly at any scale.

**Actions Can Be Triggered  
When A User Uploads Data**

**The Following Actions Can Be Triggered  
If Conditions are Met in Data Submitted**

**For Example...**



**Send QuickLink of form to  
Manager's QA/approval/completion**

**Create and assign new form as a  
result of a submitted form**

**Email custom report of  
captured data**

**Trigger an API call to an  
external system**

**Store data in external database**



A supervisor is sent a QuickLink that intelligently jumps directly to the content needing verification.



Create new hazard report form in case dangerous conditions were reported in site survey



Email invoice to specific customer visited, showing work performed



Send SMS alert to supervisor when inspection results are outside the norms



Store field work data in company ERP system SQL database



# QuickLink Feature

It is common to send notification and/or files to managers for review via trigger in a workflow or the submission of a form. TransForms new QuickLink sends a smart link to managers, insuring that they review precisely the content they need to see.

## Step 1

**When a trigger occurs  
in workflow or when  
form data is submitted...**



## Step 2

**Now QuickLink can...**

- Can take the links recipient to data that was deemed critical
- Can send a prepopulated form to an authorized user
- Can generate a whole new form derived of custom initialization data
- Can send to users or to a team's queue of tasks.

# ete System

built very quickly

A glowing lightbulb with a yellow glow, symbolizing an idea or innovation. The lightbulb is positioned on the right side of the slide, with its glow illuminating the background. The text "ete System" is written in a large, bold, black font, and "built very quickly" is written in a smaller, black font below it.

## Custom Reports

Figure 1 consists of four subplots comparing the proposed algorithm (PSO) with other algorithms (GA, ACO, BPSO, GSA, ABC, and DE) across 1000 iterations. The subplots are:

- (a) Stacked bar chart showing Average Success Rate (ASR) for 1000 iterations. The y-axis ranges from 0 to 1.0. The x-axis shows iterations from 0 to 1000. The legend indicates: GA (blue), ACO (orange), BPSO (green), GSA (red), ABC (purple), and DE (brown).
- (b) Radar chart showing Average Success Rate (ASR) for 1000 iterations. The legend indicates: GA (blue), ACO (orange), BPSO (green), GSA (red), ABC (purple), and DE (brown).
- (c) Line chart showing Average Success Rate (ASR) for 1000 iterations. The y-axis ranges from 0 to 1.0. The x-axis shows iterations from 0 to 1000. The legend indicates: GA (blue), ACO (orange), BPSO (green), GSA (red), ABC (purple), and DE (brown).
- (d) Line chart showing Average Success Rate (ASR) for 1000 iterations. The y-axis ranges from 0 to 1.0. The x-axis shows iterations from 0 to 1000. The legend indicates: GA (blue), ACO (orange), BPSO (green), GSA (red), ABC (purple), and DE (brown).

[illegible]